



REGENT SQUARE, BOW, E3

£1,650 PER MONTH

- Access to Shared Garden
- Modern Bathroom
- Great Transport Links
- Ground Floor Flat
- Large Flat
- Large Reception Room

wj.  
meade





## Regent Square

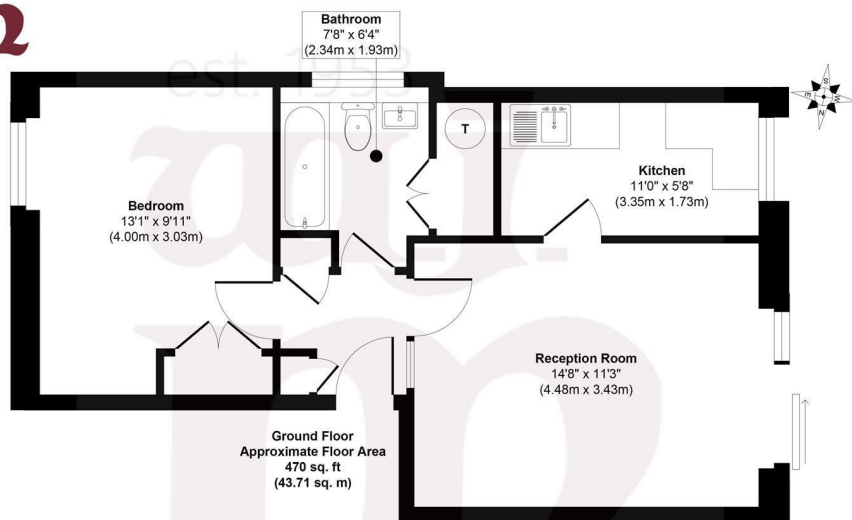

Approx. Gross Internal Floor Area 470 sq. ft / 43.71 sq. m

Illustration for identification purposes only, measurements are approximate, not to scale.  
Produced by Elements Property



W J Meade are pleased to present this one bedroom ground floor flat to rent in very quiet and secluded part of Bow. With a bright and airy feel throughout, the spacious accommodation comprises of an entrance hall providing fantastic storage, a large lounge/diner with sliding doors out to the well maintained communal gardens, a separate modern fitted kitchen, a modern fitted family bathroom and a large master bedroom. Situated moments away from Bow Church DLR, Bow Road and Bromley-By-Bow Stations, the property is well situated for great transport links.

Deposit is 5 week's rent.

Service charge £n/a  
Ground rent £n/a  
Reserve fund £n/a  
n/a years lease  
Council tax band C  
Current EPC Rating 64  
Tenure:



All sizes are approximate. The Agent has not tested any apparatus, equipment, fixtures and fittings, or services and so cannot verify that they are in working order or fit for the purpose. A buyer is advised to obtain verification from their Solicitors or Surveyor. Photographs are for illustration purposes only and may depict items, which are not for sale or included in the sale price. References to tenure of a property are based upon information supplied by the vendor. The agent has not had sight of the title documents, a buyer is advised to obtain verification from their solicitor. Money Laundering Regulations 2003: Intending purchasers will be asked to produce identification, documentation at a later stage and we would ask for your co-operation in order that there will be no delay in agreeing the sale.

These particulars are intended to give a fair description of the property only and are in no way guaranteed, nor do of any contract. They are issued on the express condition that all negotiations are conducted through W.J. Meade Estate Agents. All subject to contract and to being unsold.